

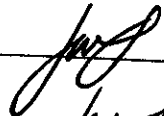



Drain: HA McMULLEN 112 Drain #: 118
 Improvement/Arm: MILLERSBURG
 Operator: J. LIVINGSTON Date: 4-12-04
 Drain Classification: Urban ~~Rural~~ Year Installed: 1938

GIS Drain Input Checklist

- Pull Source Documents for Scanning 
- Digitize & Attribute Tile Drains 
- Digitize & Attribute Storm Drains _____
- Digitize & Attribute SSD _____
- Digitize & Attribute Open Ditch 
- Stamp Plans _____
- Sum drain lengths & Validate 
- Enter Improvements into Posse _____
- Enter Drain Age into Posse 
- Sum drain length for Watershed in Posse 
- Check Database entries for errors 

Gasb 34 Footages for Historical Cost
Drain Length Log

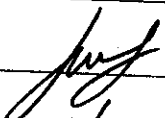
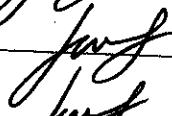
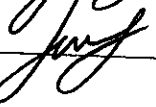
Drain-Improvement: LA M=MULLEN 1:2 - MILLERSBURG

Drain Type:	Size:	Length	Length (DB Query)	Length Reconcile	Price:	Cost:
TILE	8"	845'	845'		2 ⁰⁰ / lf	1690. ⁰⁰
* OPEN DITCH	—	168'	168		19.55 / lf	3284. ⁴⁰

Sum: 1013⁰⁰ \$ 4974.⁴⁰

Final Report: N/A

Comments:
OPEN DITCH LENGTH MEASURED IN GIS

SPECIFICATION
FOR THE REPAIR OR RECONSTRUCTION
OF THE
MILLERSBURG DRAIN

TO Roy D. Horney
Surveyor of Hamilton County
Noblesville, Indiana

3/6-21

GREETINGS:

Petition for Repair of Drain

We the undersigned residents of the town of Millersburg in Hamilton County, in the State of Indiana, hereby request you as County Surveyor, to inspect and make necessary repairs to the public drain beginning at or near the home of Fred King, near the South part of Millersburg, and running North in public street a distance of about one fourth of one mile to a point where it empties into the McMullen Drain.

Respectfully submitted,

Fred W. King
Lola Elizabeth Brewster
Mr. Floyd ...
William ...
Ruby ...

Campbell, Campbell, Malan & Kyle
Attorneys for Petitioners

MILLERSBURG DRAIN

SPECIFICATIONS AND REQUIREMENTS FOR THE CONSTRUCTION OR
RECONSTRUCTION OF THE MILLERSBURG DRAIN

The Millersburg Drain, located in the Northeast Quarter of the Southwest Quarter of Section 12, Township 20 North, Range 4 East was constructed by the W.P.A. some time about 1934 to 1938, for some reason the papers have been misplaced and were not filed in the Hamilton County Surveyor's Office as we have been unable to find any records of this Drain.

The ditch is out of order and needs repair and I would recommend a new grade, as the old grade was approximately 9 feet deep with 2 or 3 open inlets, which have been filled up and the ditch does not function. The interested parties all requesting a new ditch approximately 4.0 feet deep in practical the same location, with new open inlets constructed on side of tile so debris will not fill up the original tile.

The work to be done by machine, all work to be done in a neat and workmanlike manner.

New tile installed from station 0+00 to Station 6+20.

Existing tile from Station 6+20 to Station 8+45 (225 feet) is in good condition, except needs flushing out.

Tile enters into open drain at Station 8+45.

Clean out open ditch from Station 8+45 to the 4 foot Corrugated Pipe that crosses the East and West Highway north of Station 8+45.

Root proof tile to be installed along the existing trees as shown on the profile.

New tile to be installed and connected to existing manholes.

ESTIMATE

REQUIREMENTS:

LENGTH OF DITCH		845.0 lin. ft.	
Using old Ditch		<u>225.0</u> lin. ft.	
	New Ditch	620.0 lin. ft.	
545 lin. ft.	8 inch Tile at 34¢ per ft.		\$185.30
75 lin. ft.	8 inch Vit. Pipe at \$1.68 per ft.		125.00
12 pcs.	18 in. Bell end Sewer Pipe		
	or 36 lin. ft. @ \$1.65 per ft.		59.40
3 pcs.	18 in. Cone Grates @ \$4.50 ea.		13.50
	Extra connections		25.00
	Cement Joints in 8 in. Vit Tile around trees		<u>25.00</u>
			\$433.20
	Dig Ditch, lay tile, install manholes and connections, cement where trees are indicated, cleanout the open ditch from end of tile to lagge ipe in ditch- Labor and equipment		390.00
	Engineering, legal and miscellaneous expences		<u>136.80</u>
	Total costs		\$96.00
			\$960.00

3/21/61

Respectively submitted,

R. D. Horney, Hamilton County Surveyor

3/21/61
 3/21/61
 House Lot # 34
 Elev 45.29

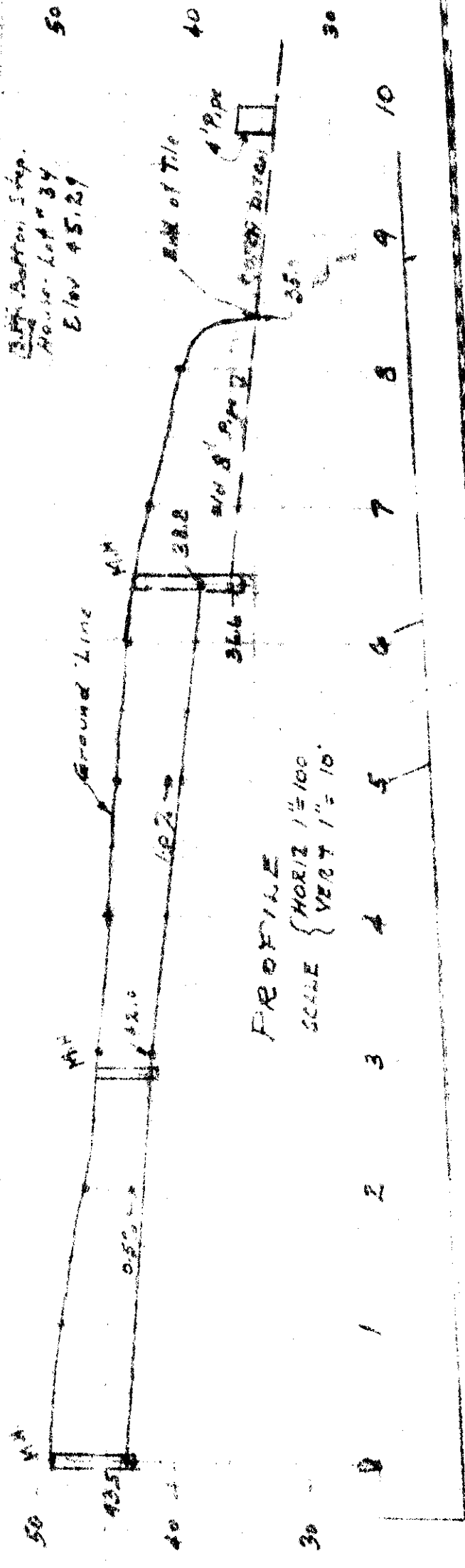

PROFILE
 SCALE { HORIZ 1"=100
 VERT 1"=10

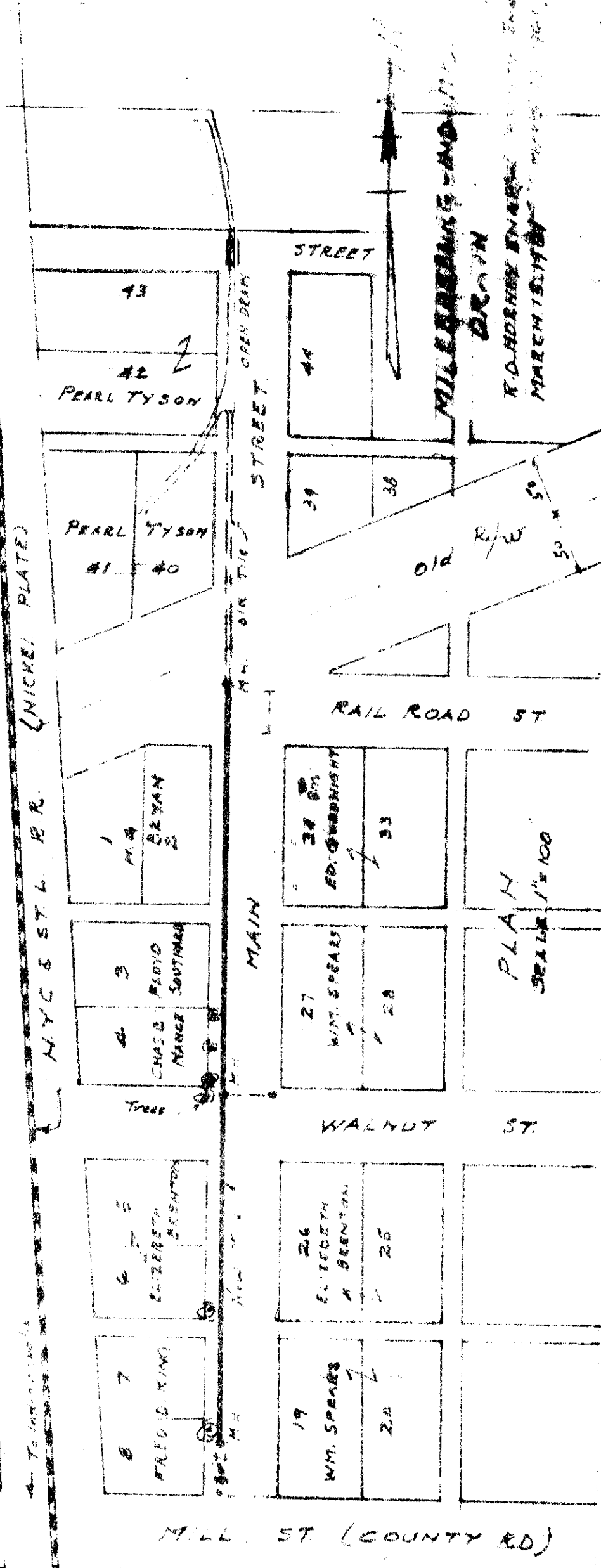

to whom it may concern

**MILLERSBURG DRAIN
SCHEDULE OF ASSESSMENTS FOR**

NAMES	DESCRIPTION OF LANDS	Section	Township	Range	Acres Assessed		Acres Benefited		Amount of Benefits		Amount of Assessment		Total Assessment	
					A	Hun	A	Hun	\$	Cts.	\$	Cts.	\$	Cts.
WM & MARY SPEARS	MILLERSBURG LOT 19	12	20	4										
	20										150	00		
	27													
	28										<u>75</u>	<u>00</u>	225	00
ELIZEBETH BRENTON	MILLERSBURG LOT 5	12	20	4										
	6										150	00		
	25													
	26										<u>75</u>	<u>00</u>	225	00
ED GOODNIGHT	MILLERSBURG LOT 33	12	20	4										
	34										<u>20</u>	<u>00</u>	20	00
FRED D KING	MILLERSBURG LOT 7	12	20	4										
	8										<u>220</u>	<u>00</u>	220	00
CHAS. & RUBY NANCE	MILLERSBURG LOT 4	12	20	4							<u>75</u>	<u>00</u>	75	00
FLOYD & EVELYN SOUTHARD	MILLERSBURG LOT 3	12	20	4							<u>60</u>	<u>00</u>	60	00
H G BRYAN & WF JERTRUDE	MILLERSBURG LOT 1	12	20	4							<u>20</u>	<u>00</u>	20	00
PEARL TYSON	MILLERSBURG LOT 40	12	20	4										
	41										<u>15</u>	<u>00</u>	15	00
	42													
	43													
HAMILTON COUNTY HIGHWAY DEPT.	MILLERSBURG MAIN STREET	12	20	4							<u>100</u>	<u>00</u>	100	00
					TOTAL									<u>\$960.00</u>

3/21/61

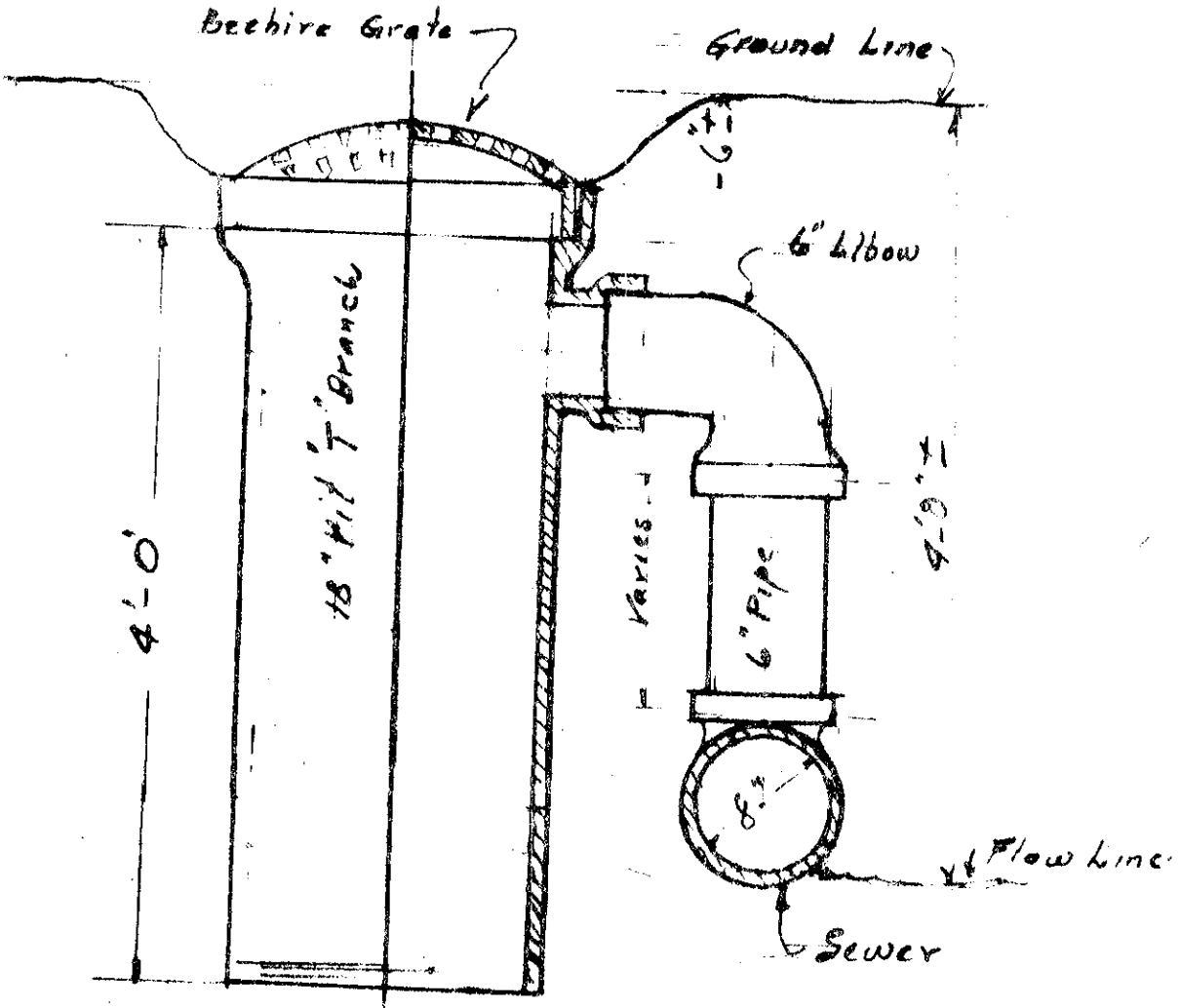

DETAIL OF INLETS - MILLERSBURG DRAIN
3- REQUIRED

3-21-61